

Main Street Downtown Development Plan

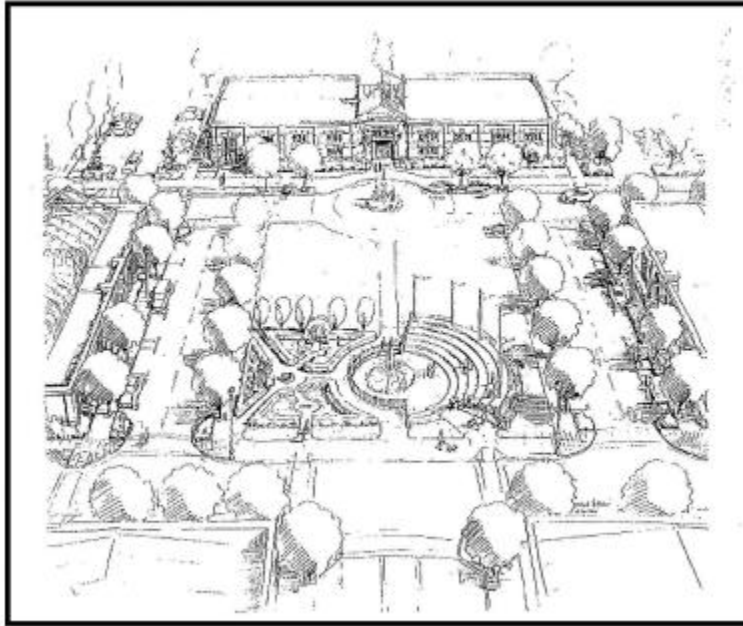

In 2001 the City of Boardman adopted a Main Street Downtown Development Plan that brought together community members to share their vision for how the core of Boardman could look. The focus was on the area south of the Interstate 84 Interchange and the plan played an important role in where City Hall is now located. As Boardman has entered another growth cycle it is a great time to take a look at what this Downtown Development Plan has to offer!

Supporting Documents

Main Street Downtown Development Plan 7.85 MB